



Springfield Close

Stanmore

£1,850 Per month

A two bedroom, ground floor maisonette available on the 10th January with Davidson Frost-Wellings.

The property is accessed via its own front door and has a spacious, bay windowed reception room, with high ceilings and a feature fireplace. There is also a separate galley kitchen, large master bedroom, additional double bedroom and a family bathroom with separate guest WC.

This maisonette further benefits from its own, private, rear garden.

Available 10th January

Deposit at the asking price of £2,134.61

Harrow Council tax band C.

- Two bedrooms
- Private garden
- Ground floor maisonette
- Available 10th January

Separate kitchen

Communal gardens

Viewing

Please contact our Davidson Frost-Wellings Office on 020 8954 8806 if you wish to arrange a viewing appointment for this property or require further information.



Floor Plan

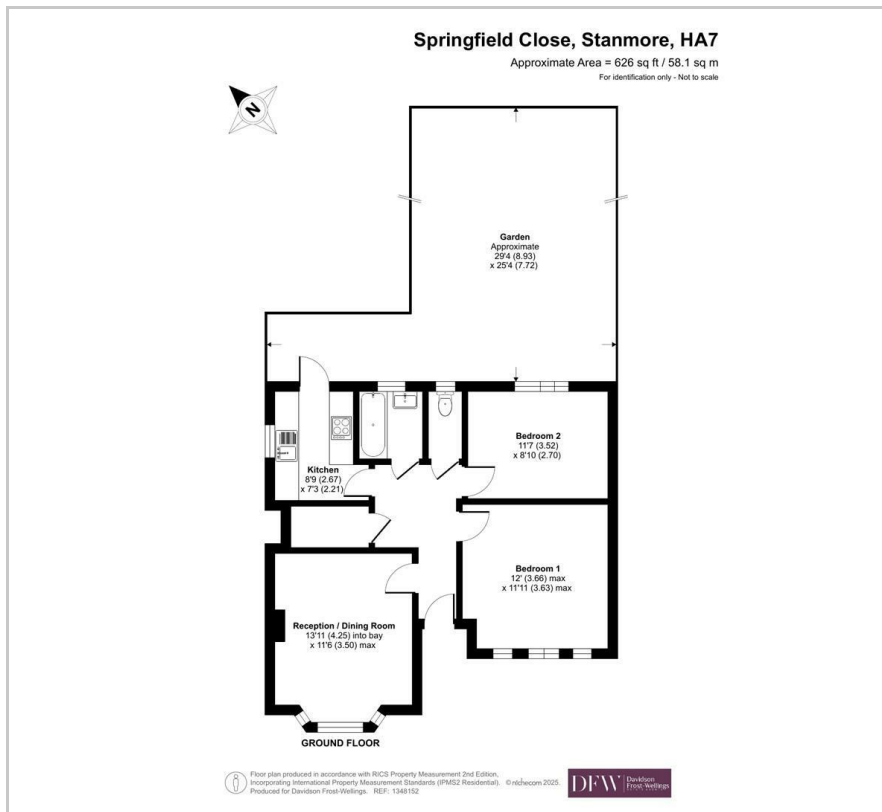

Area Map

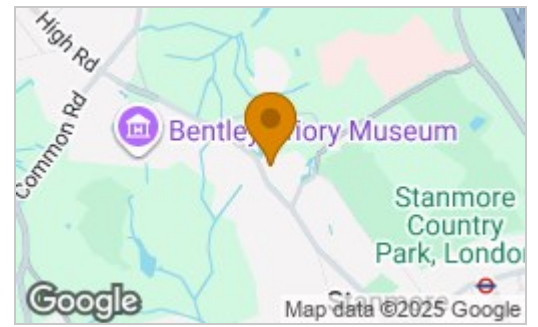

Energy Efficiency Rating

	Current	Potential
<i>Very energy efficient - lower running costs</i>		
(92 plus) A		
(81-91) B		
(69-80) C	69	72
(55-68) D		
(39-54) E		
(21-38) F		
(1-20) G		
<i>Not energy efficient - higher running costs</i>		
England & Wales	EU Directive 2002/91/EC	



These particulars, whilst believed to be accurate are set out as a general outline only for guidance and do not constitute any part of an offer or contract. Intending purchasers should not rely on them as statements of representation of fact, but must satisfy themselves by inspection or otherwise as to their accuracy. No person in this firm's employment has the authority to make or give any representation or warranty in respect of the property.